

SOLDERING AND DESOLDERING MACHINE SSM 4A AND SSM 9

MACHINES

1.107



APPLICATION: Through-hole

ZEVAC line: SSM

The complete SSM product line documentation is composed of the following data sheets:

MACHINES 1.107

ACCESSORIES 1.201

OPTIONS 1.301



APPLICATION RANGE

SELECTIVE SOLDERING AND DESOLDERING OF MULTILEAD COMPONENTS. THE SOLDERING AND DESOLDERING MACHINES OF THE SSM LINE ARE IDEAL FOR:

Repairs

Defective components can be removed and new components soldered in place.

Prototyping

Prototypes can be equipped and soldered in an efficient way with the SSM 4A and SSM 9.

Retrofits

Components which are missing at production time.
On the soldering side components have to be placed.
A SMD equipped board has to be extended by single wired components.

Soldering

When equipping boards with only few components the use of the soldering and desoldering machines SSM 4A or SSM 9 is in most cases the simplest and most economical way.

Saves time

The system's ergonomic design speeds up and simplifies your work and generates results that comply with the most stringent quality requirements.

No Restrictions

The SSM 4A and SSM 9 will dependably handle even the most difficult soldering and desoldering jobs:

- Operations on multilayer boards
- Processes components with complex geometries such as DIP switches and long connectors
- Operates on dense mixed-technology boards
- Soldering on the assembly side, even between adjacent high components
- Soldering and desoldering of Pin Grid Arrays and sockets
- Soldering on flex boards



MARKET REQUIREMENT

INCREASED SOPHISTICATION AND FAST DEVELOPING SMT HAS GENERATED AN URGENT NEED FOR A TRULY PROFESSIONAL SOLUTION TO SOLDER AND DESOLDER COMPONENTS OF THE THROUGH-HOLE TECHNIC IN A PROFESSIONAL WAY. FOR SELECTIVE SOLDERING AND DESOLDERING OF CONNECTORS AND OTHER HIGH QUALITY MULTIPOLAR COMPONENTS. SSM 4A AND SSM 9 MEET THESE REQUIREMENTS IN A PARTICULAR WAY.

Enhanced effectiveness

- Fast positioning with the air nozzle.
- Soldering and desoldering at the same time/position.
- Reliable blow-out of solder holes from above, immediately after removal of the device.

Enhanced quality

- Precise adjustment of soldering parameters
- Reproducible results
- Non mechanical stress protects device and circuit board against damage
- Adjacent devices are protected during soldering process. Heat is isolated to a single component.

PREHEATER MODULE PH4

Option for SSM 4A and SSM 9

The preheater module PH4 is required for the preheating of printed circuit board before starting the selective soldering process, especially for lead-free applications.

The preheater PH4 with an IR radiation area of 300x300mm and a thermal output of 3500W is a standalone unit and can be operated together with any SSM 4A or SSM 9 machine.



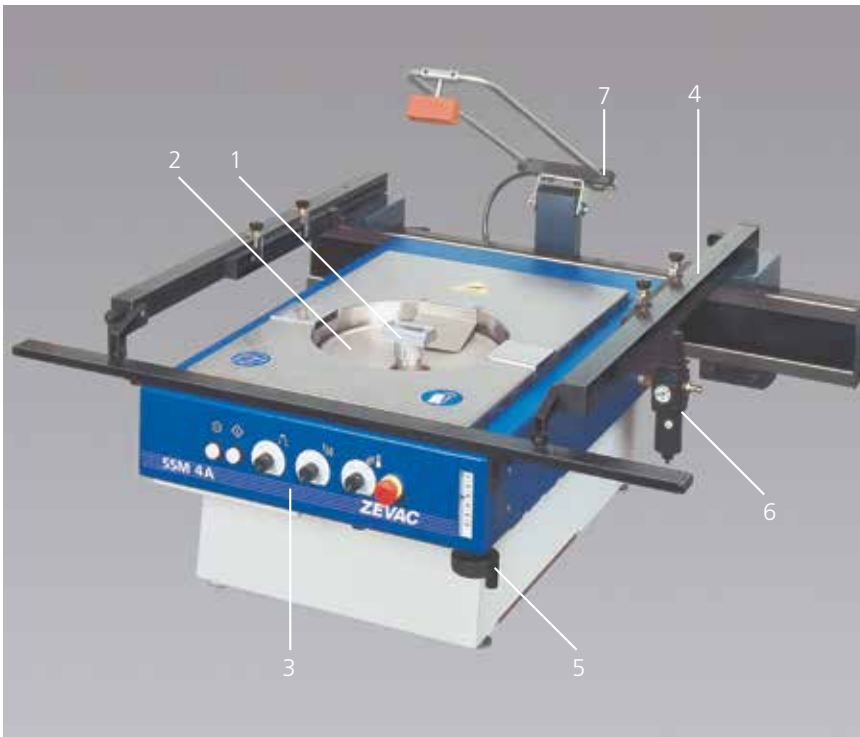

SSM 4A:

Unique in performance and design:

- 1 Flow well
- 2 Solder pot
- 3 Control panel
- 4 Print holder
- 5 Height adjustment for board carrier
- 6 Connection for optional blow-out system
- 7 Blow-out system (option)



Control panel:
Clearly arranged operation and control

- 1 Main switch ON/OFF
- 2 Cycle switch
- 3 Solder wave height
- 4 Solder wave duration
- 5 Temperature control
- 6 Emergency switch

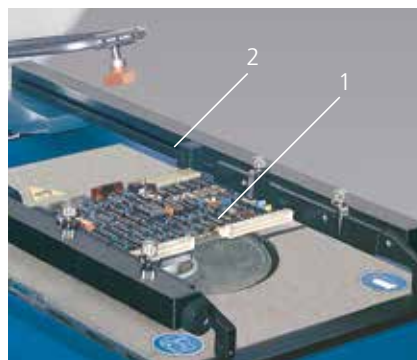

Print holder:
For easy positioning

- 1 Printed Circuit Board
- 2 Print holder



Flow well:
Safe soldering and desoldering

| | | |
|----------------------------------|------------------------|-----------------------|
| Technical data | Product designation | SSM 4A |
| | Max. board size | 600 x 600 mm |
| | Pumping system | solder pump |
| | Heat up time | approx. 30 min. |
| | Cycle duration | 0 - 60 s |
| | Air pressure | 1 - 8 bar |
| | Solder temperature | 200° C - 300° C |
| | Max. power consumption | 2500 Watt |
| | Power requirements | 220 - 230 Volt, 50 Hz |
| | Dimensions (L x W x H) | 440 x 800 x 360 mm |
| | Solder content | approx. 16 kg |
| Weight (without solder) | 47 kg | |
| Technical data subject to change | | |

Dimensions

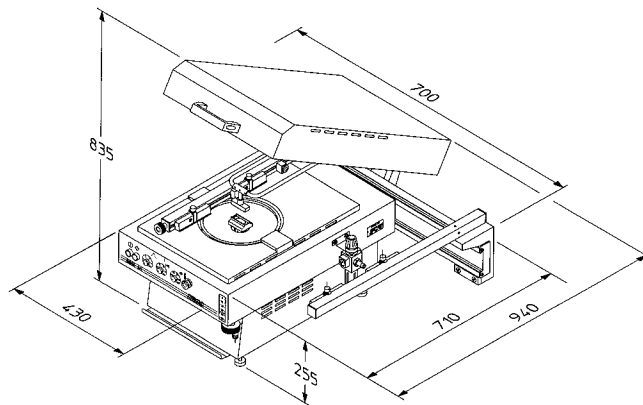

| | | |
|--------------------------------|---------------------------------------|-------------------------|
| Accessories and options | Flow wells and cleaning hoods | Data sheet 1.201 |
| | Print holder support | Order no. 209.025.000 |
| | Single footswitch | Order no. 249.000.708 |
| | Blow out unit incl. double footswitch | Order no. 204.032.015 |
| | Solder pot cover | Order no. 209.033.002 B |
| | Fume extraction | Order no. 209.034.000 |
| | IR preheater PH4 SSM | Order no. 206.002.000 |
| | Cover hood | Order no. 209.033.000 |
| | Protective gas covering | Order no. 204.035.000 |
| | Button protection | Order no. 204.021.003 |



SSM 9:

Unique in performance and design:

- 1 Flow well
- 2 Cleaning hood
- 3 Solder pot
- 4 Control panel
- 5 Board carrier
- 6 Height adjustment board carrier
- 7 Lock
- 8 Footswitch
- 9 Cover hood (Option)
- 10 Fume extraction (Option)

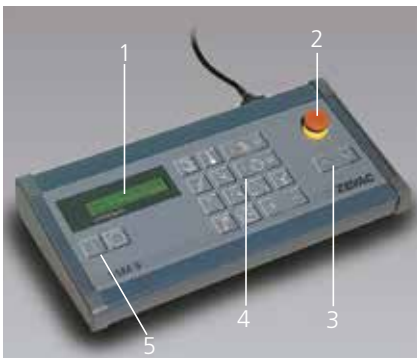

Control panel:
Clearly arranged operation and control

- 1 Display
- 2 Emergency switch
- 3 Motorized Z-axis (Option)
- 4 Input (Foil keyboard)
- 5 ON/OFF switch

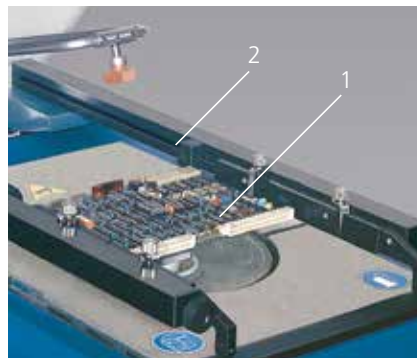

Board carrier:
For easy positioning

- 1 Printed Circuit Board
- 2 Board carrier



Flow well:
Safe soldering and desoldering

| | | |
|-----------------------|----------------------------------|-----------------------|
| Technical data | Product designation | SSM 9 |
| | Max. board size | 840 x 600 mm |
| | Pumping system | solder pump |
| | Heat up time | approx. 30 min. |
| | Cycle duration | 0 - 60 s |
| | Air pressure | 1 - 8 bar |
| | Solder temperature | 235° C - 400° C |
| | Max. power consumption | 2500 Watt |
| | Power requirements | 220 - 230 Volt, 50 Hz |
| | Dimensions (L x W x H) | 440 x 800 x 360 mm |
| | Solder content | approx. 16 kg |
| | Weight (without solder) | 75 kg |
| | Technical data subject to change | |

Dimensions

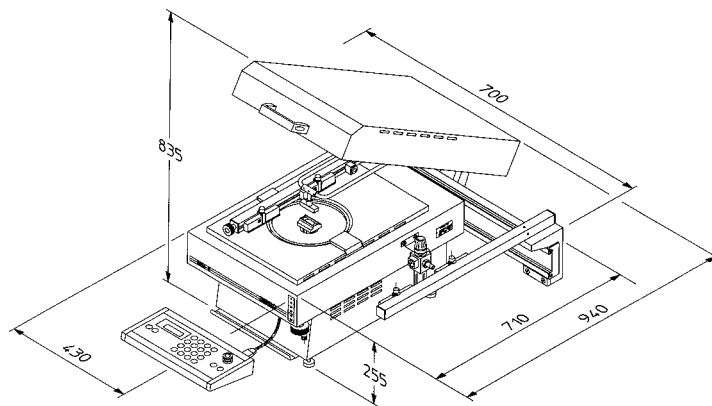

| | | |
|--------------------------------|-------------------------------|-------------------------|
| Accessories and options | Flow wells and cleaning hoods | Data sheet 1.201 |
| | Print holder support | Order no. 209.025.000 |
| | Blow-out system | Order no. 209.032.000 |
| | Solder pot cover, round | Order no. 209.033.002 B |
| | Fume extractio | Order no. 209.034.000 |
| | IR preheater PH4 SSM | Order no. 206.002.000 |
| | Cover hood | Order no. 209.033.000 |
| | Protective gas covering | Order no. 209.035.000 |

ZEVAC Distributor

ZEVAC

ZEVAC AG
Vogelherdstrasse 4
CH - 4500 Solothurn / Switzerland

Telephone +41 32 626 20 80
Fax +41 32 626 20 90
E-mail info@zevac.ch
Website www.zevac.ch